



B2704 BASE

DIY KIT INSTRUCTION MANUAL



PREP PARTS AND WORK AREA BEFORE STARTING

- Make sure you are working on a sturdy, flat work surface that will not scratch or damage the parts while handling.
- Lightly sand and deburr the part edges if needed.
- It is recommended to dry fit (construct without glue) the parts to familiarize yourself with the assembly process.

RECOMMENDED TOOLS FOR BASE CONSTRUCTION

- Wood Glue
- 30" Bar Clamps (4)
- #2 Philips Screw Driver
- Rubber Mallet or Hammer
- Electric Drill
- Router (Optional)
- 3/16" Roundover Bit
- 80, 120 and 150 Grit Sandpaper
- 90 Degree Square
- Choice of Stain/Finish
- Drill Bits: 3/32", 3/16", 7/16" and #25
- Paraffin wax
- Drawer bead bit if desired

Please Note: If you are not going to start building the chest right away, you will need to weight down the parts. The parts are unfinished and can warp if left in the box for extended periods of time. Gerstner is not responsible for replacing warped parts 15 days after receipt.

BASE SIDES

- 1 Install the Lid Slide Plate w/nails on each side.

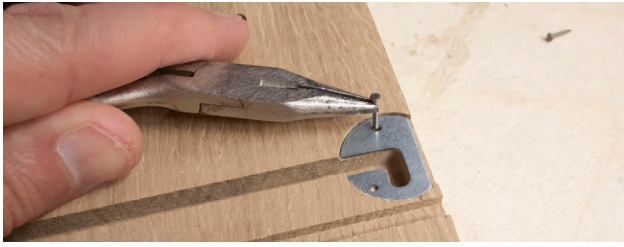

DRAWER SLIDES

- 2 Install the drawer slides: Glue the maple drawer slides in the grooves on the side. The maple drawer slides are a snug fit in the groove and a little extra sanding/fitting may be needed. Use glue lightly and use a hammer/ rubber mallet to tap the slides into the grooves.



DRAWER PARTITIONS

- 3 Glue the Maple Drawer Slides in the grooves of the Birch Plywood Small Partitions with Cap. If the maple drawer slides are tight in the groove, use a rubber mallet to tap the slides into the grooves. Flip the partition over and repeat.



TOP PANEL ASSEMBLY

- 4 Glue the small partitions with the solid wood cap facing the front edge of the top partition. It is shown upside down during assembly. The narrow plywood stinger is installed in the rear position. The hardwood stringer is installed in the front position and must set flush to the short partitions.

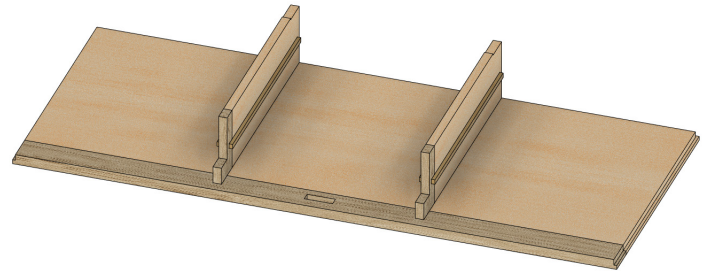

**Front edge has hardwood trim or cap as shown*

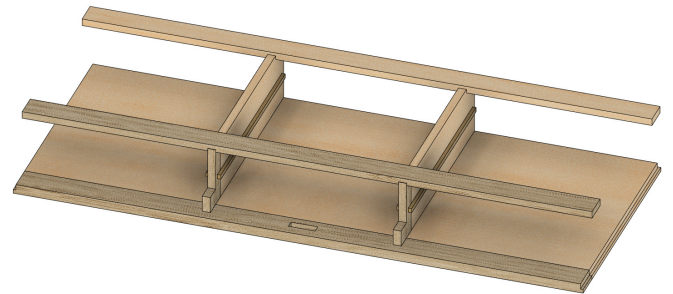
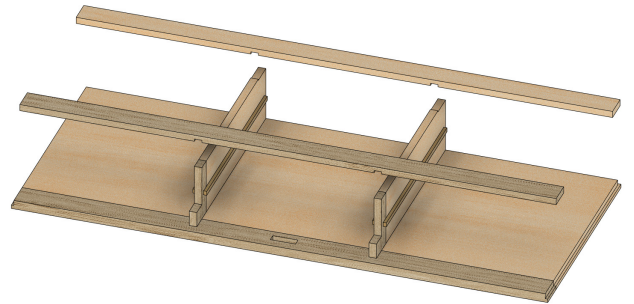

BOX ASSEMBLY

- 5 It is recommended that you pre-assemble the box **WITHOUT** glue to familiarize yourself with the process.

Start with one of the sides laying down on the workbench and begin to assemble the chest. Make sure you match your pace with the curing time of the glue.

Install top sub-assembly into side as shown.



OPTIONAL HANDLE INSTALLATION

(SOLD SEPARATELY)

We've made it easy to add handles to your **B2704 Base**. Use the pre-drilled 5 hole pattern on the inside of both side panels as a guide to drill 1/8" holes all the way through. The holes will line up for Gerstner's **Part #1015 Nickel Side Handles**, or **Part #1016 Brass Side Handles** (both come with screws).



Scan to shop for handles.

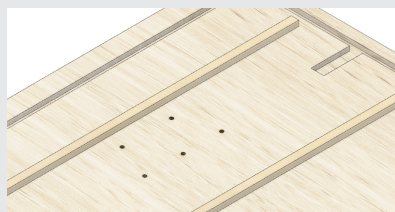

BOX ASSEMBLY (CONTINUED)

- 6** Install back of chest into side as shown. Make sure the grooves for the top and bottom of chest are aligned. If the grooves do not line up with one another chances are the back panel is upside down.



- 7** Install the box bottom as shown, make sure the back panel is flush at the top and bottom edge of the side.



- 8** Install remaining chest side as shown, It will be a little challenging to get all of the parts in their proper grooves. Take your time and ensure all edges are flush and construction is correct.

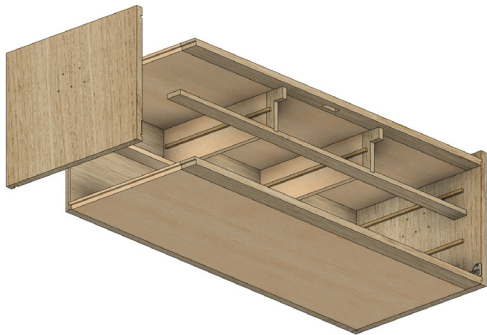

- 9** Clamp the assembled chest with bar clamps and clean up any excess glue that has squeezed out of the joints. Ensure that the chest is square and all parts are flush and aligned correctly. *It might also be necessary to clamp the chest front to back as well.*

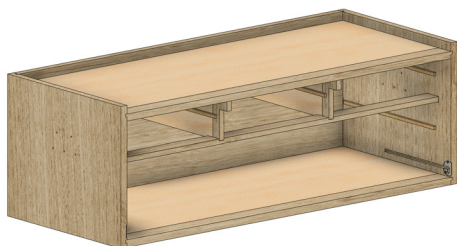

FRONT LID ASSEMBLY

- 10** Install lid end rail as show, the parts have been marked with a pencil line to indicate the front face. All lines should be on the same front face if assembled correctly.



- 11** Slide the front lid panel into lid assembly making sure the matching hardwood shows to the front. Make sure the end rails set flush on the outside edges.



- 12** Install remaining long lid rail as shown and check for square. Clamp lid together and clean up any excess glue squeezed from the parts.



- 13** Place lock into hole from backside and pre-drill a 3/32" hole for screw holes.



Be careful to not drill through wood.
CAUTION: Do not mount or drill lock on front face of lid.

Have Questions? Call us at (937) 228-1662,
or email us at Gerstner@GerstnerUSA.com

DRAWER FRONTS: KNOB HOLE MACHINING

- 14** Mark the knob location on the inside of the drawer face.

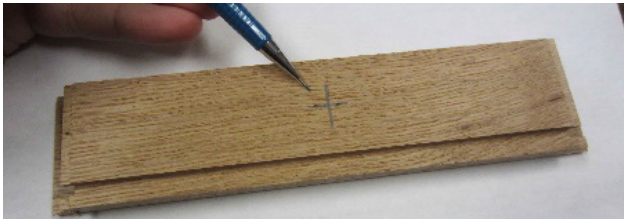

- 15** Drill a 3/16" hole at the desired location.



- 16** Using a 7/16 drill, countersink or forstner bit, countersink for screw head.

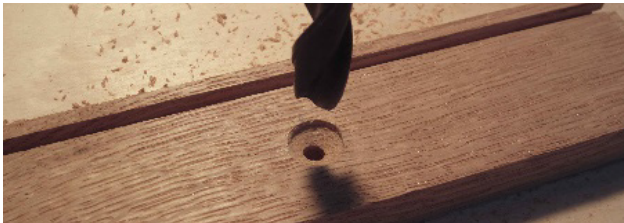

- 17** Set the countersink depth so the screw sticks out 1/4" from the face.

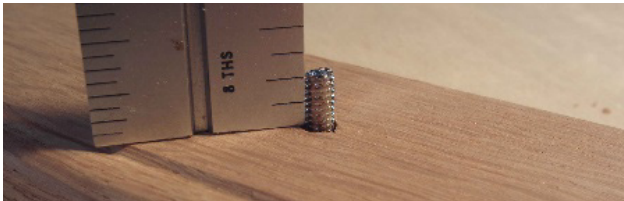

- 18** Sand location marks from wood.



- 19** Knob hole machining is complete.



DRAWER ASSEMBLY

- 20** Because the drawers are assembled the same way regardless of size we will only be covering assembly of one single drawer.

Assemble the drawer front and back into the drawer side as shown. The drawer front should set flush at the top and stick below the bottom edge by 1/16".



- 21** Slide the 1/8" thick plywood drawer bottom into the drawer as shown. The drawer bottom can be glued into place or float without being glued into the drawer.



- 22** Install the remaining drawer side and clamp the drawer together. Make sure the drawer is square and all excess glue has been removed. Continue this process for all remaining drawers.

SANDING AND FINISHING

- 23** Flush-up all joinery. This may be done with a flush cut router bit or by hand sanding. Take extra care in flushing-up the chest top and back.*
***CAUTION: We use veneer plywood on the back of this chest.** This plywood gives the box stability through ever changing conditions of humidity. Please note that you must exercise great care when sanding the back surface. The veneer is .010" thick and excessive sanding on these areas can cause a sand-through, to the plywood core below the veneer. We suggest you sand the solid wood just enough to meet the surface of the veneer.

- 24** Round over edges of the chest as desired. The corner protectors have a 3/16" radius.



- 25** Fit the drawers to the box making sure that the gaps between the drawers are uniform. Because all wood swells under certain conditions, a drawer fit with minimal clearance is not recommended. (Gerstner recommends 1/32"-1/16" gap on all sides of the drawer.)



- 26** Final sand all parts of your chest to desired grit. (Gerstner recommends at least 150 grit).



STAINING & FINISHING

- 27** Stain and finish the parts as desired. Gerstner stains and then applies 1-2 coats of a lacquer sealer and then 1-2 top coats of lacquer. (Make sure to use a style finish that you are comfortable working with.)



Many options exist for adding a protective finish to your wood project. Select the finish of your choice and apply as desired. If using the recommended Gerstner Classic Wood Stains with lacquer top coat, please follow the directions listed below.

- 28** Prior to finishing, remove any hardware that was installed during drilling. Lightly re-sand the exterior surfaces to remove any scratches or contamination (oils from your skin). This will allow for a quality finish.

- 29** Apply stain to inside edges, and exterior surfaces as desired. Wipe excess stain from the surface and make sure the color has been evenly applied.



- 30** Apply a lacquer finish to the chest. Lightly sand the first coat, or seal coat, once dry with 320 grit sand paper.



- 31** Apply top coat to parts as desired and let finish fully cure before handling.

FELT INSTALLATION



A 50/50 mix of white glue and water can be used for felt installation. We recommend **Gerstner Whew Glue** for all felt applications, as it holds reliably, yet is easy to replace if you ever need to re-felt in the coming years. It is the only felt glue we use in our workshop.

32 Brush the mixture onto the surface and then carefully press the felt into place.



33 All felt pieces have been pre-cut to fit the base top, drawers and back of front lid.



34 After all felt has been installed, let the chest sit open for a few hours to dry.

35 Install hardware on the chest as desired. The 4 rubber bumpers are mounted on the bottom of the chest, using the (4) 3/8" screws. The screw goes through the rubber bumper and through the hole in the leg of the bottom corner.



FRONT LID PINS

36 Once the front lid has been fit to the chest, you will need to drill for the Front Lid Pins with a 5/32" diameter drill bit. The locations for the holes are shown below.

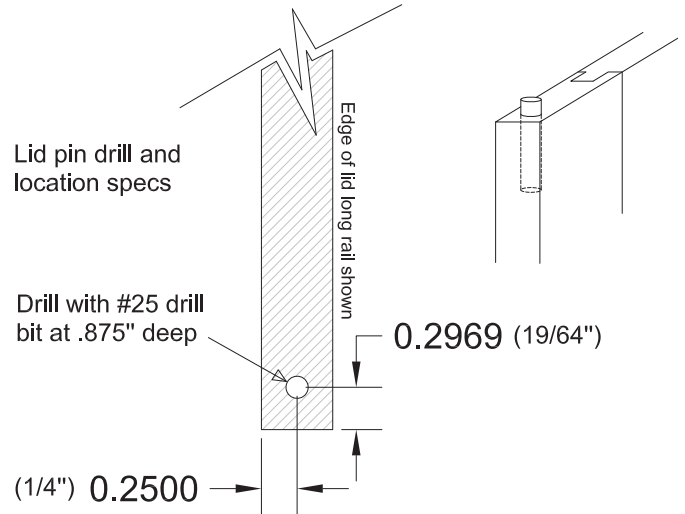

37 Install both lid pins in the front lid. The pins should protrude about 1/8" from the edge of the front lid. The 2 felt dots will be put in the bottom of the chest, 3/4" from the front edge to keep the front lid from rubbing against the bottom of the chest.



Scan to watch a brief video on how to install your front lid in your chest

38 Rub paraffin wax onto the drawers and the inside of the chest to help the drawers glide smoothly.

PARTS LIST: DIY KIT STYLE B2704 BASE

WOOD PARTS LIST QUANTITY

- Top panel 1
- Bottom panel 1
- Back panel 1
- Left side panel 1
- Right side panel 1
- Hardwood Stringer 1
- Plywood Stringer 1
- Short partitions 2
- Maple drawer slides 8
- Lid end rails 2
- Long lid rails 2
- Front lid panel 1
- Small drawer faces 3
- Large drawer face 1
- Small left drawer sides 3
- Small right drawer sides 3
- Large left drawer side 1
- Large right drawer side 1
- Small drawer backs 3
- Large drawer back 1
- Small drawer bottoms 3
- Large drawer bottom 1

HARDWARE PARTS LIST QUANTITY

- Felt for box and drawers 6
- Box corners with screws 4
- Rubber bumpers 4
- Drawer pull knobs 5
- Gerstner Workshop nameplate with nails 1
- Base lock with screws 1
- Lid pins 2
- Lid slide plates with nails 2
- Felt lid supports 2

We would love to see your Gerstner Workshop project pictures! Post and visit us at:

- Facebook.com/GerstnerUSA
- Instagram.com/GerstnerUSA

Find helpful Gerstner tips and tricks at:

- Youtube.com/@GerstnerUSA

For any questions or additional supplies, please contact customer service.

Email: Gerstner@GerstnerUSA.com

Customer Support line: (937) 228-1662



Gerstner Workshop is a division of
H. GERSTNER & SONS, INC.
 20 Gerstner Way, Dayton, Ohio 45402

GERSTNERUSA.COM



CONGRATULATIONS!

You have built an heirloom quality Gerstner chest that will last for generations. Keep your fine wood chest in tip top shape by using Gerstner Finish Restorer and Preserver.

Scan to watch a brief video demonstration of cleaning with Gerstner Finish Restorer and Preserver



DID YOU ENJOY BUILDING YOUR NEW B2704 BASE?

Check out all of the other Gerstner Workshop DIY Kits at www.GerstnerUSA.com.



STYLE #2609
MASTERCRAFTSMAN CHEST
 DIY KIT